

Electronic Ballast for MH60 Lamps

Input range 12 V

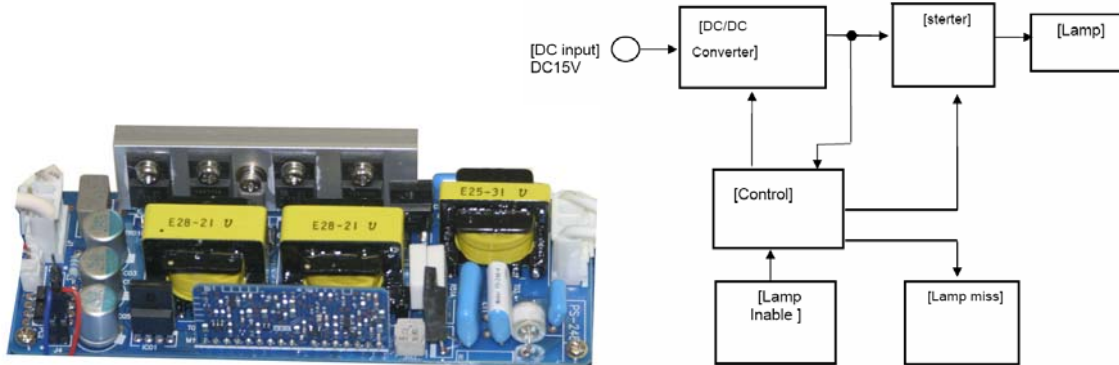

Data sheet electronic Ballast MH60 lamps DC12V

This specification shall apply to the lamp driver (M66SBS) to operate a 60WDC lamp.

This lamp driver is designed and adjusted for the metalhalide lamp (ArcMeister)

Standard Applied [The lamp driver is designed to meet these standards when mounted in the set.]

Safety Standard UL60950,CSA950,IEC950,EN60950,EN60065
[DENAN,UL60950,CSA950,IEC950,EN60950,EN60065]

EMI FCC CLASSB,EN55022 CLASSB EN50082-1 [DENAN,VCCI
CLASS2,FCC CLASSB,EN55022 CLASSB, EN50082-1]

Advantages:

- Very small diamensions
- Input range 11-18V DC
- Two power settings: 40W/60W
- Wide temperature range
- Small output ripple

General Specifications

Cooling method	Forced-air cooling	A forced air-cooling is required Where an electricity output exceeds $[0.3\text{m}^3/\text{min}]^*1$
Operational ambient temperature	+0°C - +60°C	
Storage ambient temperature	-20°C+70°C	non condensing
Storage relative humidity	5-90%RH	non condensing
Rated Input Voltage VIN(V)	Min/max DC11~18V	DC12~15V
Input Power (W) Nomal input	73W±5%	Input voltage DC15V (49 Ω impedance)
Input Power (W) Low-Mode [J4-short]	48W±5%	Input voltage DC15V (75.6 Ω impedance)
Input Voltage Ripple Vr (Vpp)	3 % max	10kHz
Input current Iin(A)	6.5A max	10A max 0.5mSec
Maximum wattage	80 W max	
Output power		
Vs inputs	60W±5%	VIN=DC11-18V VL=70V
Normal-Mode [Vs outputs]	60W±5%	VL=55-100V, VIN=DC15V (VL=100-120V VsOut-8%,+5% (VL=45-55V,Vsout +5%,-10%)
Low-Mode [J4-Short Mode]	40W±7%	VL=55-100V, VIN=DC15V (VL=100-115V, VsOut-10%,+5% (VL=45-55V,Vsout +5%,-12%)
Peak voltage during ignition	5.7kV 0-P	VIN=DC15V 5.0-7.5kV0-p
Cycle of HV during ignition	70cycle	V IN=DC15V
Ignition time	less than 4.5 sec.	V IN=DC15V 3.0-4.5Sec
Outputs protection		
short current protection	2.0 A	Vsout <15V
over voltage protection	150±20V	
thermal protection	112 ±15°C	
Low-InputVoltage	10 ± 0.5V	
Operating frequency	70± 5kHz	
Weight	170g	

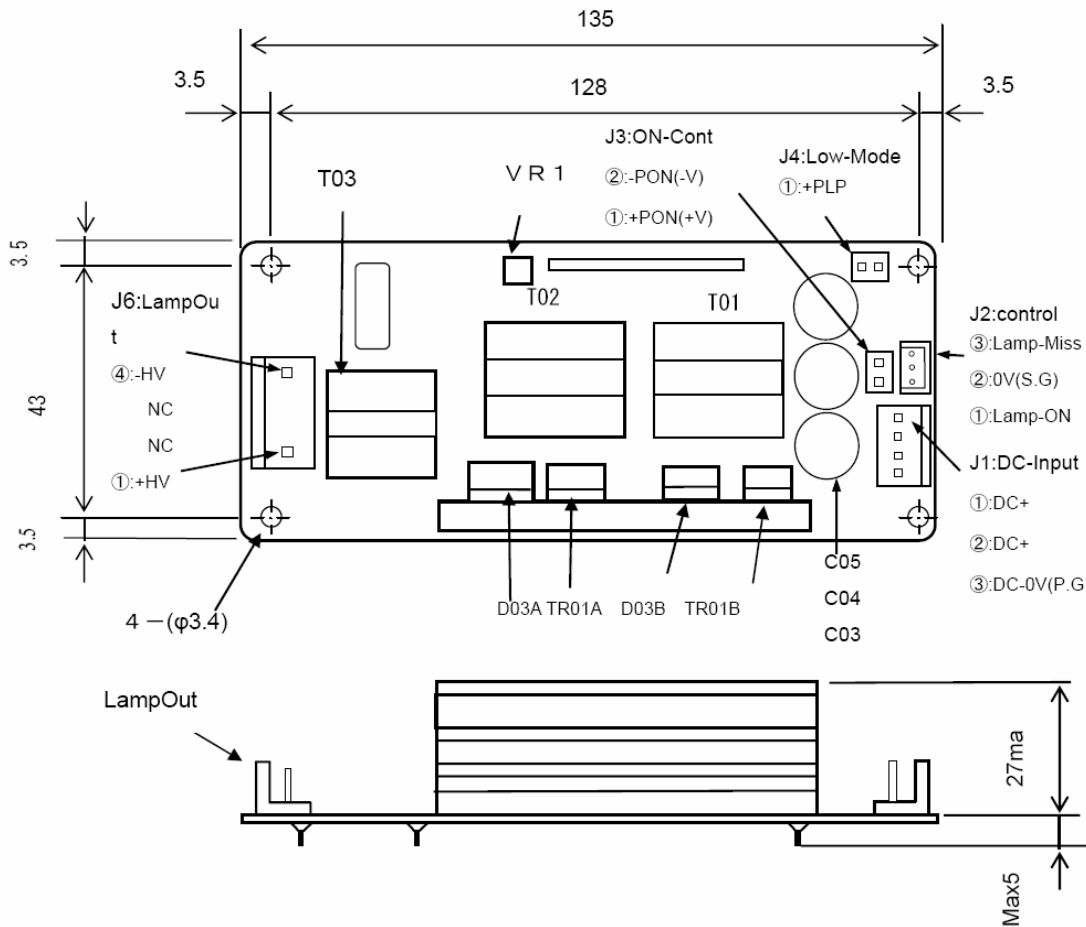

TechnoLab Systems GmbH
 Am Borsigturm 46
 13507 Berlin
 Tel.: +49 30 4303 3160
 Fax: +49 30 4303 3169

Specification of interface J1 B4P-VHXX [(J.S.T Mfg CO.,Ltd. B4P-VHxx)

Pin No. 1	DC+	+Vcc
Pin No. 2	DC+	+Vcc
Pin No. 3	DC-(common)	0V
Pin No. 4	DC-(common)	0V

Specification of interface J2 (B3B-PH-K) [(J.S.T Mfg CO., Ltd. B3B-PH-K (-S))

Pin No. 1	LAMPON	ON/OFF(2mA~VON~5mA) [Lamp ON/OFF(2mA~VON~5mA)]
Pin No. 2	0V (S.G)	GND (S.G)
Pin No. 3	LAMPMISS	(I _{miss} ~3mA) [Lamp lighting signal.]

Specification of interface J3 On-Cont [Output control] RE-Pin-Heder

Pin No. 1	+PON	+V
Pin No. 2	-PON	-V

Specification of interface J4 Low-Mode [Output Power Low-Mode control] RE-Pin-Heder

Pin No. 1	+PLP	+V
Pin No. 2	-PLP	-V

Specification of interface J6 Lamp connector (B2P4-VHXX) [(J.S.T Mfg CO.,Ltd. B2P4-VHxx)

Pin No. 1	+HV	Lamp-Out : Cauton Hight Voltage Strat Ignition Voltage abut ±2.5kV0-p
Pin No. 2	NC	
Pin No. 3	NC	
Pin No. 4	-HV	

Please have 5mm between ballast and object

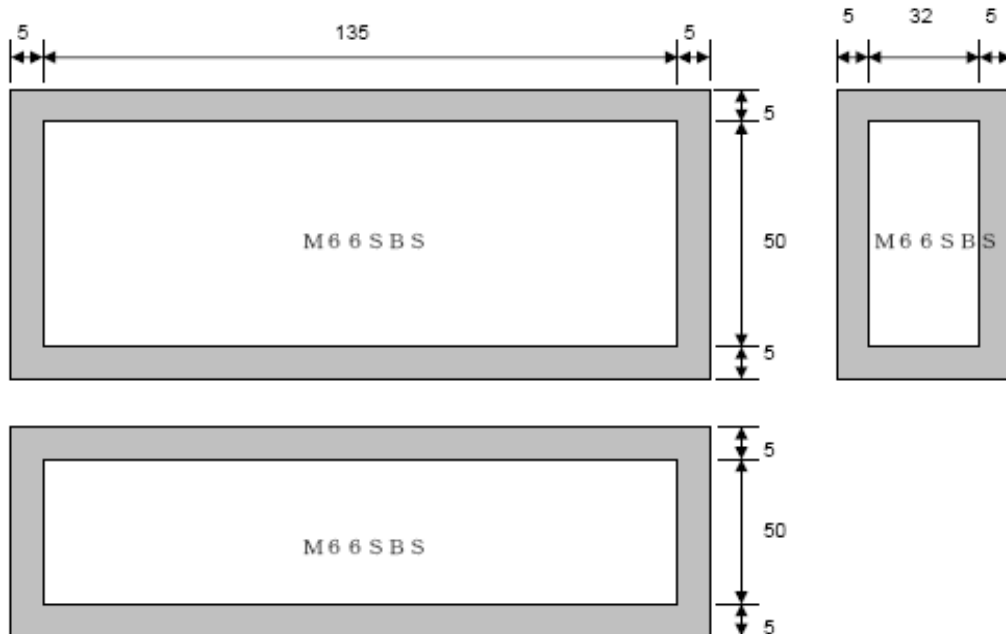

TechnoLab Systems GmbH
 Am Borsigturm 46
 13507 Berlin
 Tel.: +49 30 4303 3160
 Fax:+49 30 4303 3169